

"LONGBRANCH"

PART OF
SECTIONS 28 AND 33, TOWNSHIP 1 SOUTH, RANGE 21 EAST
BAKER COUNTY, FLORIDA.

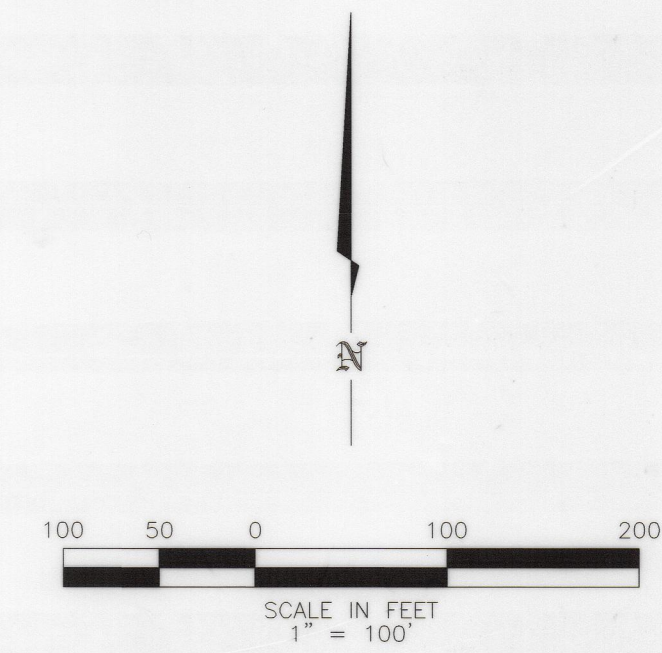

CURVE	DELTA	RADIUS	LENGTH	TANGENT	CHORD BEARING	CHORD DISTANCE
C7	22°17'37"	630.00	245.13	124.14	S 05°34'03" W	243.59
C8	24°12'46"	570.00	240.88	122.26	N 06°31'37" E	239.09
C12	06°13'28"	570.00	61.92	30.99	S 02°28'01" E	61.89
C13	17°59'18"	570.00	178.95	90.22	S 09°38'22" W	178.22
C14	22°37'39"	618.62	244.31	123.77	S 05°44'04" W	242.72
C15	23°55'15"	578.34	241.46	122.51	N 08°22'52" E	239.71

- LEGEND:
- ⊙ = FOUND 1/2" IRON ROD
 - = FOUND 1/2" IRON PIPE UNLESS OTHERWISE NOTED
 - = SET 1/2" IRON PIPE WITH YELLOW CAP STAMPED LB 6888
 - = P.R.M. SET 4"x4" CONCRETE MONUMENT WITH METAL PLATE STAMPED LB 6888
 - = FOUND 4"x4" CONCRETE MONUMENT UNLESS OTHERWISE NOTED
 - ⊕ = POWER POLE
 - x — = FENCE
 - OU — = OVERHEAD UTILITY LINES
 - P.L.S. = PROFESSIONAL LAND SURVEYOR
 - L.S. = LICENSED SURVEYOR
 - R.L.S. = REGISTERED LAND SURVEYOR
 - P.R.M. = PERMANENT REFERENCE MONUMENT

- SURVEYOR'S NOTES:
- 1.) A BEARING OF N 11°15'48" W WAS ASSUMED ON THE WEST LINE OF THE EAST 1/2 OF SECTION 28 SHOWN HEREON, HOLDING MONUMENTATION SHOWN FOUND IN PLACE.
 - 2.) PROPERTY HEREON LIES IN FLOOD ZONE "X" AND IS DETERMINED TO BE OUTSIDE THE 500 YEAR FLOOD PLAIN AS SCALED FROM FLOOD INSURANCE RATE MAP 120419 0135, DATED 7/16/91. (BEING OUTSIDE THE 500 YEAR FLOOD PLAIN WOULD ALSO INDICATE BEING OUTSIDE THE 100 YEAR FLOOD PLAIN.)
 - 3.) WATER SOURCE TO BE INDIVIDUAL PRIVATE WELLS AND WASTE WATER DISPOSAL TO BE INDIVIDUAL SEPTIC TANKS.
 - 4.) MINIMUM LOT SIZE IS 5.00 ACRES ON EXISTING PAVED ROADS, 7.5 ACRES ON COUNTY MAINTAINED GRADED ROADS.
 - 5.) THE CONTOUR LINES SHOWN ARE SCALED FROM 1:24000 U.S. GEOLOGICAL SURVEY QUADRANGLE MAP, MACCLENNY WEST AND MACCLENNY NW.
 - 6.) WETLANDS SHOWN WERE TAKEN FROM THE NATIONAL WETLANDS INVENTORY MAPS.
 - 7.) THE DEVELOPER KNOWS OF NO HISTORIC AND ARCHAEOLOGICAL SITES ON THE PROPERTY SITE, OR WITHIN ONE THOUSAND FEET OF ANY BOUNDARY OF THE SITE.

SHEET 5 OF 7

LD BRADLEY
LAND SURVEYORS

**5773 NORMANDY BOULEVARD,
JACKSONVILLE, FLORIDA 32205**
PHONE **786-6400** FAX (904) 786-1479
LICENSED BUSINESS No. 6888

W.O. NO.: 02-162	SURVEY DATE: 5/24/02	DRAFTED BY: DHB
CHECKED BY: AJJ	CAD FILE: 02162.DWG	FB 393 PG 25-73

TIMBERLAND ESTATES
PLAT BOOK 3, PAGES 3 & 4



MATCH LINE SEE SHEET 4 OF 7

SEE SHEET 1 FOR LEGAL DESCRIPTIONS
THIS MAP IS NOT COMPLETE WITHOUT SHEETS 1 THROUGH 7

CERTIFIED A TRUE, COMPLETE AND CORRECT COPY
BY **AL FRANK**
BAKER COUNTY CLERK OF THE COURTS