

"LONGBRANCH"

PART OF
SECTIONS 28 AND 33, TOWNSHIP 1 SOUTH, RANGE 21 EAST
BAKER COUNTY, FLORIDA.

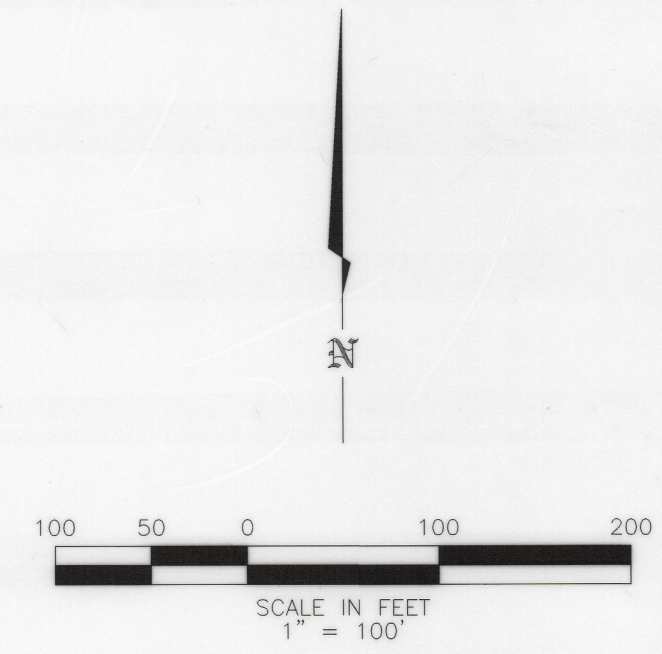
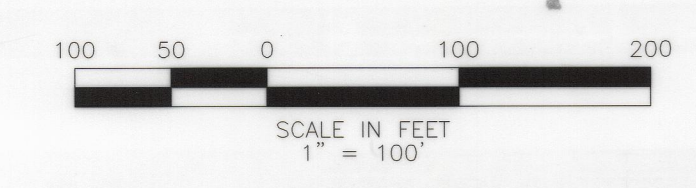

CURVE TABLE						
CURVE	DELTA	RADIUS	LENGTH	TANGENT	CHORD BEARING	CHORD DISTANCE
C1	23°16'50"	530.00	215.35	109.18	N 37°10'57" E	213.87
C2	31°16'13"	980.00	534.85	274.27	N 09°54'26" E	528.24
C3	23°16'50"	470.00	190.97	96.82	S 37°10'57" W	189.66
C4	31°16'13"	920.00	502.11	257.48	S 09°54'26" W	495.90
C9	11°19'44"	980.00	193.77	97.20	N 19°52'40" E	193.45
C10	19°17'37"	980.00	330.00	166.58	N 04°34'00" E	328.44
C11	0°38'53"	980.00	11.08	5.54	N 05°24'15" W	11.08

- LEGEND:
- = FOUND 1/2" IRON ROD
 - = FOUND 1/2" IRON PIPE UNLESS OTHERWISE NOTED
 - = SET 1/2" IRON PIPE WITH YELLOW CAP STAMPED LB 6888
 - = P.R.M. SET 4"x4" CONCRETE MONUMENT WITH METAL PLATE STAMPED LB 6888
 - = FOUND 4"x4" CONCRETE MONUMENT UNLESS OTHERWISE NOTED
 - ⊙ = POWER POLE
 - X — = FENCE
 - O — = OVERHEAD UTILITY LINES
- P.L.S. = PROFESSIONAL LAND SURVEYOR
L.S. = LICENSED SURVEYOR
R.L.S. = REGISTERED LAND SURVEYOR
P.R.M. = PERMANENT REFERENCE MONUMENT

- SURVEYOR'S NOTES:
- 1.) A BEARING OF N 11°15'48" W WAS ASSUMED ON THE WEST LINE OF THE EAST 1/2 OF SECTION 28 SHOWN HEREON, HOLDING MONUMENTATION SHOWN FOUND IN PLACE.
 - 2.) PROPERTY HEREON LIES IN FLOOD ZONE "X" AND IS DETERMINED TO BE OUTSIDE THE 500 YEAR FLOOD PLAIN AS SCALED FROM FLOOD INSURANCE RATE MAP 120419 0135, DATED 7/16/91. (BEING OUTSIDE THE 500 YEAR FLOOD PLAIN WOULD ALSO INDICATE BEING OUTSIDE THE 100 YEAR FLOOD PLAIN.)
 - 3.) WATER SOURCE TO BE INDIVIDUAL PRIVATE WELLS AND WASTE WATER DISPOSAL TO BE INDIVIDUAL SEPTIC TANKS.
 - 4.) MINIMUM LOT SIZE IS 5.00 ACRES ON EXISTING PAVED ROADS, 7.5 ACRES ON COUNTY MAINTAINED GRADED ROADS.
 - 5.) THE CONTOUR LINES SHOWN ARE SCALED FROM 1:24000 U.S. GEOLOGICAL SURVEY QUADRANGLE MAP, MACCLENNY WEST AND MACCLENNY NW.
 - 6.) WETLANDS SHOWN WERE TAKEN FROM THE NATIONAL WETLANDS INVENTORY MAPS.
 - 7.) THE DEVELOPER KNOWS OF NO HISTORIC AND ARCHAEOLOGICAL SITES ON THE PROPERTY SITE, OR WITHIN ONE THOUSAND FEET OF ANY BOUNDARY OF THE SITE.

SHEET 2 OF 7

LD BRADLEY
LAND SURVEYORS

**5773 NORMANDY BOULEVARD,
JACKSONVILLE, FLORIDA 32205**
PHONE (904) 786-6400 FAX (904) 786-1479
LICENSED BUSINESS No. 6888

W.O. NO.: 02-162	SURVEY DATE: 5/24/02	DRAFTED BY: DHB
CHECKED BY: AJJ	CAD FILE: 02162.DWG	FB 393 PG 25-73

CERTIFIED A TRUE, COMPLETE AND CORRECT COPY
 BEFORE ME, COUNTY CLERK OF THE COURTS
 BY **AL FRANK**
 COUNTY CLERK

