

PINEHURST - VILLA - IN THE - HIGHLANDS

BAKER COUNTY FLORIDA

1925

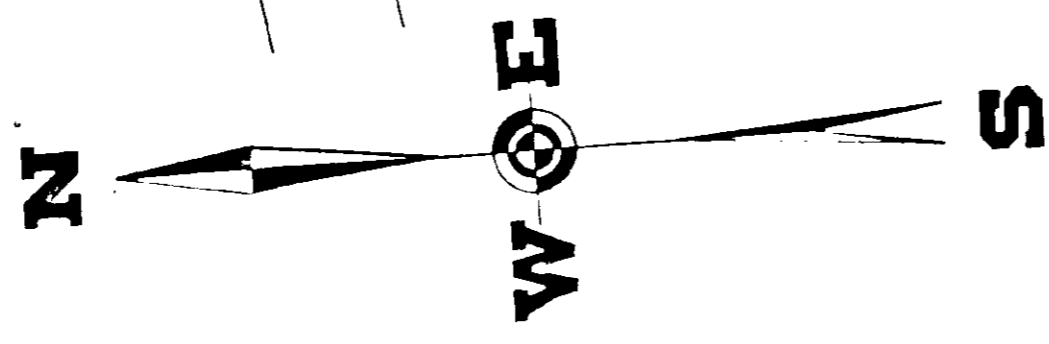
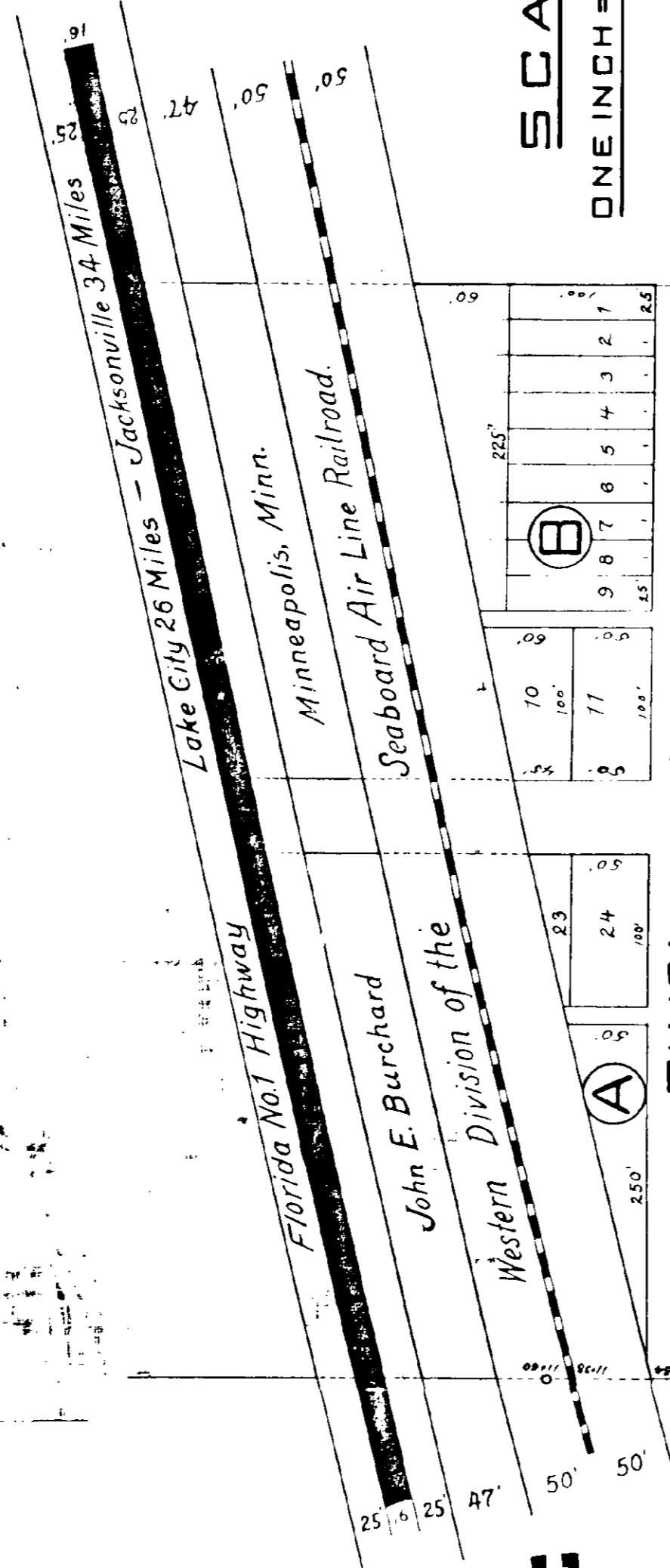

SCALE
ONE INCH = 60 FEET

NOTES

The Magnetic Variation is One Degree and Thirty Minutes East. The Soil is Sandy Loam, with Clay Subsoil, thus preserving moisture. The Elevation of the Townsite varies from 130 to 140 feet above Sea Level, tempering summer heat and reducing humidity.

OWNERS' CERTIFICATE

Know All Men By These Presents - That I, J.W. Overturn of Indianapolis, Indiana, do hereby dedicate for a townsite purpose certain streets and alleys, as indicated in this Plat of Pinehurst and more particularly described in the Engineers Statement, being located in the Southwest Corner of the Southwest Quarter of Section 5-3-24-E, Baker County, Florida. Said Streets and alleys are hereby transferred for Public use, and said Lots are set apart for sale to the Public on Transfer to the Purchasers thereof, as provided under the Laws of the State of Florida, for the conveyance of Real Estate.

Witness the Names and Seals of the said J.W. Overturn and of Jeannette V. Overturn, his wife on this 30th day of July, A.D. 1925

Witnesses:
(Signature)
(Signature)

NOTARY'S CERTIFICATE

I hereby certify that on this 30th day of July, A.D. 1925, before me, a Notary Public in and for said County and State, personally appeared J.W. Overturn and Jeannette Overturn, his wife, who being sworn, did then and there execute the foregoing document and they acknowledged the execution thereof to be their free act and deed; the wife making her declaration of said intentions separately and apart from her husband, and in presence of my Signature and my official Seal on this day and year.



ENGINEER'S STATEMENT

I hereby certify that this Plat of Pinehurst is based on actual field surveys made by me personally, that the circle in the lower left hand corner represents the South-West Section Corner of Section Five 1st Township, Three South (3S) and in Range Twenty-one, East (21E); that the west line of the Tract runs N 48 E 160 feet to the N.W. Corner of the SW 4 SW 4 of said section; that the distance on the South line of Broadway to the center line of Indiana Avenue is 744 feet, and that the center line of said Avenue is the eastern boundary of said Townsite and the limit of conveyance affecting said Townsite; that the South boundary of the railroad is the north boundary of the townsite; and finally I certify that said Tract contains Twenty Acres (20A). All dimensions are placed on the Plat for future reference and convenience of which I verily believe to be true and correct.

(Signature)
 Civil Engineer

RECORD OF FILING

I hereby certify that this original Plat was received on the day of July, A.D. 1925 and that it has been filed and recorded in the Public Records of Baker County, Florida in Plat Book No. 1 and on Page 10 thereof.

(Signature)
 County Court Clerk

1925 30 18 S. E. Cor. of Quarter